

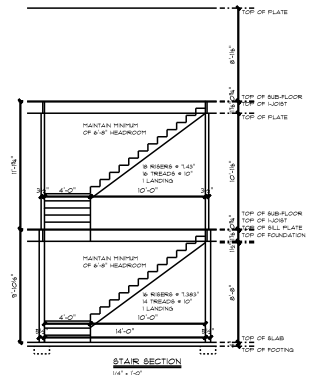

REAR ELEVATION



RIGHT ELEVATION



STAIR SECTION  
1/4" = 1'-0"

This CAD design is not an architectural plan. You and your architect shall bear the responsibility to determine that the CAD meets all local building codes and requirements. The user assumes all responsibility for the CAD. The user shall be responsible for all substitutions, omissions or modifications for proper use of materials and construction techniques and for the resulting building.

**GENERAL NOTES**

1. All elevations are from edge of framing to edge of framing unless noted otherwise.
2. Exterior framing sets are shown as built with concrete foundation, unless as shown, e.g., 4" x 4" in place concrete foundation.
3. House exterior framing sets height is shown as 9'-11" and 10'-11" to its floor and 8'-11" to its roof.
4. Stairing framing sets height is regulated by floor system and rise.
5. Roof pitch is shown as 20° with 2'-0" O.D. from framing at eave and 3'-0" O.D. from framing at gable ends (eave and gable).
6. Window dimensions, if indicated, are R. O. sizes.
7. Dimensions indicated are reference, show actual dimensions.

DATE	BY	REVISED
03/23/05	JK	1
03/23/05	JK	2
03/23/05	JK	3
03/23/05	JK	4
03/23/05	JK	5
03/23/05	JK	6
03/23/05	JK	7
03/23/05	JK	8
03/23/05	JK	9
03/23/05	JK	10
03/23/05	JK	11
03/23/05	JK	12
03/23/05	JK	13
03/23/05	JK	14
03/23/05	JK	15
03/23/05	JK	16
03/23/05	JK	17
03/23/05	JK	18
03/23/05	JK	19
03/23/05	JK	20
03/23/05	JK	21
03/23/05	JK	22
03/23/05	JK	23
03/23/05	JK	24
03/23/05	JK	25
03/23/05	JK	26
03/23/05	JK	27
03/23/05	JK	28
03/23/05	JK	29
03/23/05	JK	30
03/23/05	JK	31
03/23/05	JK	32
03/23/05	JK	33
03/23/05	JK	34
03/23/05	JK	35
03/23/05	JK	36
03/23/05	JK	37
03/23/05	JK	38
03/23/05	JK	39
03/23/05	JK	40
03/23/05	JK	41
03/23/05	JK	42
03/23/05	JK	43
03/23/05	JK	44
03/23/05	JK	45
03/23/05	JK	46
03/23/05	JK	47
03/23/05	JK	48
03/23/05	JK	49
03/23/05	JK	50
03/23/05	JK	51
03/23/05	JK	52
03/23/05	JK	53
03/23/05	JK	54
03/23/05	JK	55
03/23/05	JK	56
03/23/05	JK	57
03/23/05	JK	58
03/23/05	JK	59
03/23/05	JK	60
03/23/05	JK	61
03/23/05	JK	62
03/23/05	JK	63
03/23/05	JK	64
03/23/05	JK	65
03/23/05	JK	66
03/23/05	JK	67
03/23/05	JK	68
03/23/05	JK	69
03/23/05	JK	70
03/23/05	JK	71
03/23/05	JK	72
03/23/05	JK	73
03/23/05	JK	74
03/23/05	JK	75
03/23/05	JK	76
03/23/05	JK	77
03/23/05	JK	78
03/23/05	JK	79
03/23/05	JK	80
03/23/05	JK	81
03/23/05	JK	82
03/23/05	JK	83
03/23/05	JK	84
03/23/05	JK	85
03/23/05	JK	86
03/23/05	JK	87
03/23/05	JK	88
03/23/05	JK	89
03/23/05	JK	90
03/23/05	JK	91
03/23/05	JK	92
03/23/05	JK	93
03/23/05	JK	94
03/23/05	JK	95
03/23/05	JK	96
03/23/05	JK	97
03/23/05	JK	98
03/23/05	JK	99
03/23/05	JK	100

CREATIVE INTERIORS, INC. - NEW HOME  
 DRAWING NUMBER: 147-1-027  
 PROJECT: NEW HOME  
 DATE: 03/23/05

FRARY LUMBER & SUPPLY  
 REAR & RIGHT ELEVATIONS

OF 5